



McCAULEY™

# Revision Transmittal Sheet

SL2024-2

May 12, 2025

This sheet transmits Revision 1 to SL2024-2, which:

1. Added McCauley Propeller Models 2A36C23, 3A32C76, 3A32C406, D3A32C409, 3AF32C504, 3AF32C505, D3A34C420, 3A34C423, 3AF37C510 and 3AF37C516.
2. Added Compliance section to the service document.
3. Added Consumable Material section to the service document.
4. Added MPC400, Model C400 Series Propeller Overhaul Manual and MPC500, Model C500 Series Propeller Overhaul Manual to the Reference Publications section.
5. Added Accomplishment Instructions Steps 1 thru 6 to the service document.
6. Added Material Information and Parts Table to the service document.

Original Issue	November 1, 2024
Revision 1	May 12, 2025

\* \* \* \* \*



# SERVICE LETTER



## MANDATORY

May 12, 2025

SL2024-2A

### TITLE

C-4044 ADAPTER PLATE ALTERNATIVE

### TO:

FAA-Approved Propeller Repair Stations, Aircraft Manufacturers, Owners and Operators

### MODELS AFFECTED

All with McCauley Propellers listed in the table below:

2A37C223	B2A37C228	2A36C23	3A32C76
3A32C406	D3A32C409	3AF32C504	3AF32C505
D3A34C420	3A34C423	3AF37C510	3AF37C516

### REASON

To replace the C-4044 Adapter Plate with an improved D-40004 Slip Ring Plate.

### DESCRIPTION

This service document provides parts and instructions to replace the C-4044 Adapter plate with an improved D-40004 Slip Ring Plate. Failure to comply with this document could result in damage to the propeller and nose cowling.

Original Issue: November 1, 2024

Page 1 of 9

TO OBTAIN SATISFACTORY RESULTS, PROCEDURES SPECIFIED IN THIS SERVICE INFORMATION MUST BE ACCOMPLISHED IN ACCORDANCE WITH ACCEPTED METHODS AND PREVAILING GOVERNMENT REGULATIONS. MCCAULEY PROPELLER SYSTEMS CANNOT BE RESPONSIBLE FOR THE QUALITY OF WORK PERFORMED IN ACCOMPLISHING THIS SERVICE INFORMATION.

McCauley Propeller Systems  
PO Box 7704  
Wichita, Kansas 67277-7704

COPYRIGHT © 2024 McCauley Propeller Systems

# SERVICE LETTER



## MANDATORY

SL2024-2A

### COMPLIANCE

MANDATORY. This service document must be accomplished within 100 flight hours or 12 months from the date of receipt, whichever occurs first.

A service document published by Textron Aviation may be recorded as *completed* in an aircraft log only when the following requirements are satisfied:

- 1) The mechanic must complete all of the instructions in the service document, including the intent therein.
- 2) The mechanic must correctly use and install all applicable parts supplied with the service document kit. Only with written authorization from McCauley can substitute parts or rebuilt parts be used to replace new parts.
- 3) The mechanic or airplane owner must use the technical data in the service document only as approved and published.
- 4) The mechanic or airplane owner must apply the information in the service document only to propeller model numbers identified in the *Model Affected* section of the document.
- 5) The mechanic or airplane owner must use maintenance practices that are identified as acceptable standard practices in the aviation industry and governmental regulations.

No individual or corporate organization other than McCauley is authorized to make or apply any changes to a McCauley-issued service document without prior written consent from McCauley.

McCauley is not responsible for the quality of maintenance performed to comply with this document, unless the maintenance is accomplished at a Textron Aviation-owned Service Center.

### APPROVAL

McCauley has received FAA approval for the technical data in this publication that changes the airplane type design.

### CONSUMABLE MATERIAL

You must use the consumable materials that follow, or their equivalent, to complete this service document.

NAME	NUMBER	MANUFACTURER	USE
Safety Wire	MS20995C32	Commercially Available	Safety Wire Adapter Plate Screws

### REFERENCE PUBLICATION

MPC200, Model C200 Series Propeller Overhaul Manual  
MPC400, Model C400 Series Propeller Overhaul Manual  
MPC500, Model C500 Series Propeller Overhaul Manual

### PUBLICATIONS AFFECTED

None

### ACCOMPLISHMENT INSTRUCTIONS

1. Using a high intensity light, examine the adapter plate installed between the spinner bulkhead and propeller attach flange for the correct adapter plate.

# SERVICE LETTER



## MANDATORY

SL2024-2A

- A. If the installed adapter plate looks like Detail A, go to Step 2.
- B. If the installed adapter plate looks like Detail B, go to Step 7.

C2850

C-4044  
Adapter Plate  
(Reference)



**A**

D-40004  
Adapter Plate  
(Reference)



**B**

C-4044  
D-40004

- 2. Remove the propeller from the aircraft. (Refer to McCauley Owner/Operator Information Manual, Chapter 61, Constant Speed Reciprocating Engine Propeller - Removal and Installation (Piston).)
- 3. Remove the spinner bulkhead from the aircraft. (Refer to McCauley Owner/Operator Information Manual, Chapter 61, Spinner Bulkhead Assembly - Removal and Installation.)
- 4. (Refer to Figure 1, Sheets 1, 2, 3 or 4 depending on the propeller series.) Replace the C-4044 Propeller Adapter Plate as follows:
  - A. Remove the spinner bulkhead from the propeller hub by lifting the bulkhead from the propeller hub studs.
  - B. Cut and remove the safety wire from the screws that attach the C-4044 Adapter plate to the spinner bulkhead.
  - C. Remove and discard the screws and washers that attach the C-4044 Adapter plate to the spinner bulkhead.
  - D. Install one D-40004 Adapter Plate to the spinner bulkhead using twelve A-1635-36 Screws and A-1638-20 Washers.

**NOTE:** During installation of the adapter plate make sure the flat side of the adapter plate faces forward toward the propeller hub. Make sure to align one propeller hub stud hole on adapter plate with center nut plate on spinner bulkhead. This will make sure the adapter plate attachment holes are aligned correctly.
  - (1) Torque the screws to 23.0 (± 3.0) inch pounds.
  - E. Safety wire the twelve A-1635-36 Screws in pairs of two (double twist method) using MS20995C32 Safety Wire.
  - F. Install the spinner bulkhead onto the propeller hub studs.

# SERVICE LETTER



## MANDATORY

SL2024-2A

5. Install the propeller on the aircraft. (Refer to McCauley Owner/Operator Information Manual, Chapter 61, Constant Speed Reciprocating Engine Propeller - Removal and Installation (Piston).
6. Remove the maintenance warning tags and connect the airplane battery.
7. Make an entry in the airplane logbook that states compliance and method of compliance with this service document.

**NOTE:** Textron Aviation recommends that compliance with all service documents is reported to a maintenance tracking system provider.

- Complete a record of compliance. (Maintenance Transaction Report, Log Book Entry, or other record of compliance.)
- Put a copy of the completed record of compliance in the airplane logbook.
- Send a copy of the completed record of compliance to the maintenance tracking system provider used.

# SERVICE LETTER

**MANDATORY**

**SL2024-2A**

C2846

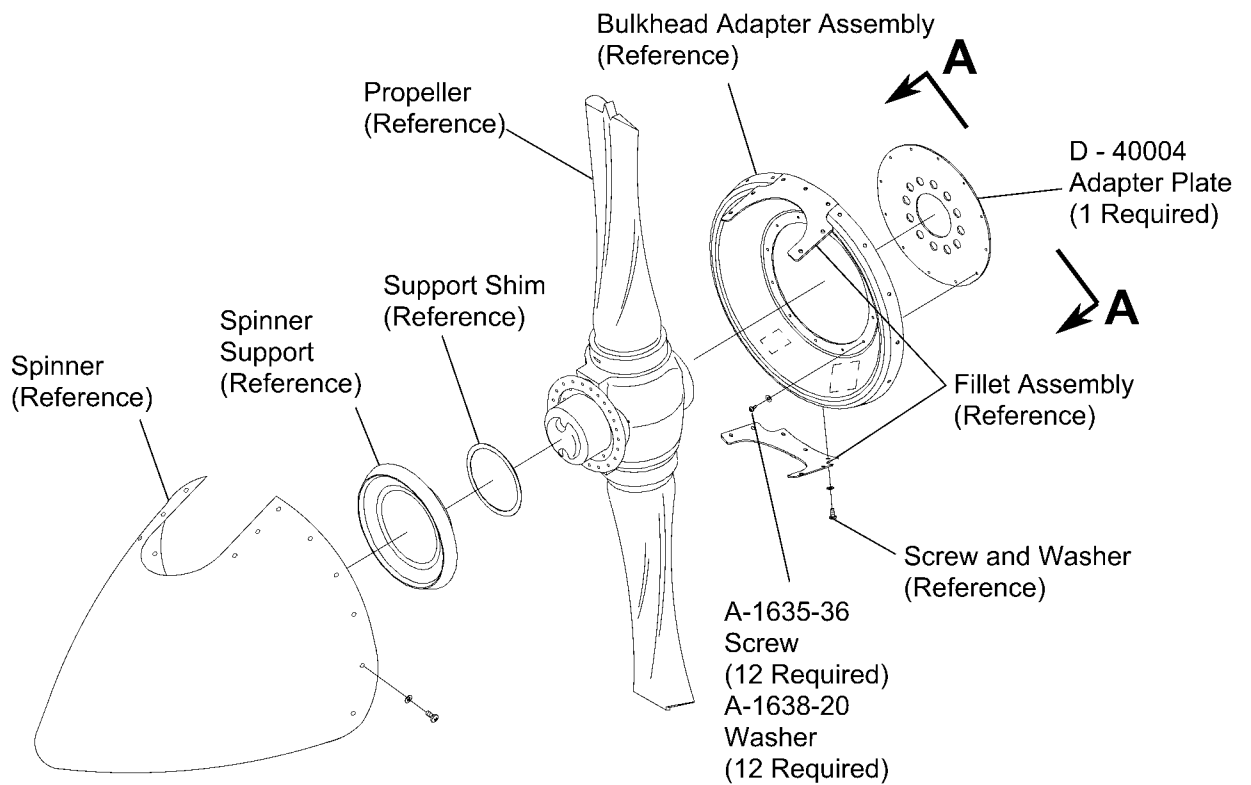

200 Series Propeller

Figure 1. Propeller Adapter Plate Replacement (Sheet 1)

# SERVICE LETTER



**MANDATORY**

**SL2024-2A**

C2847

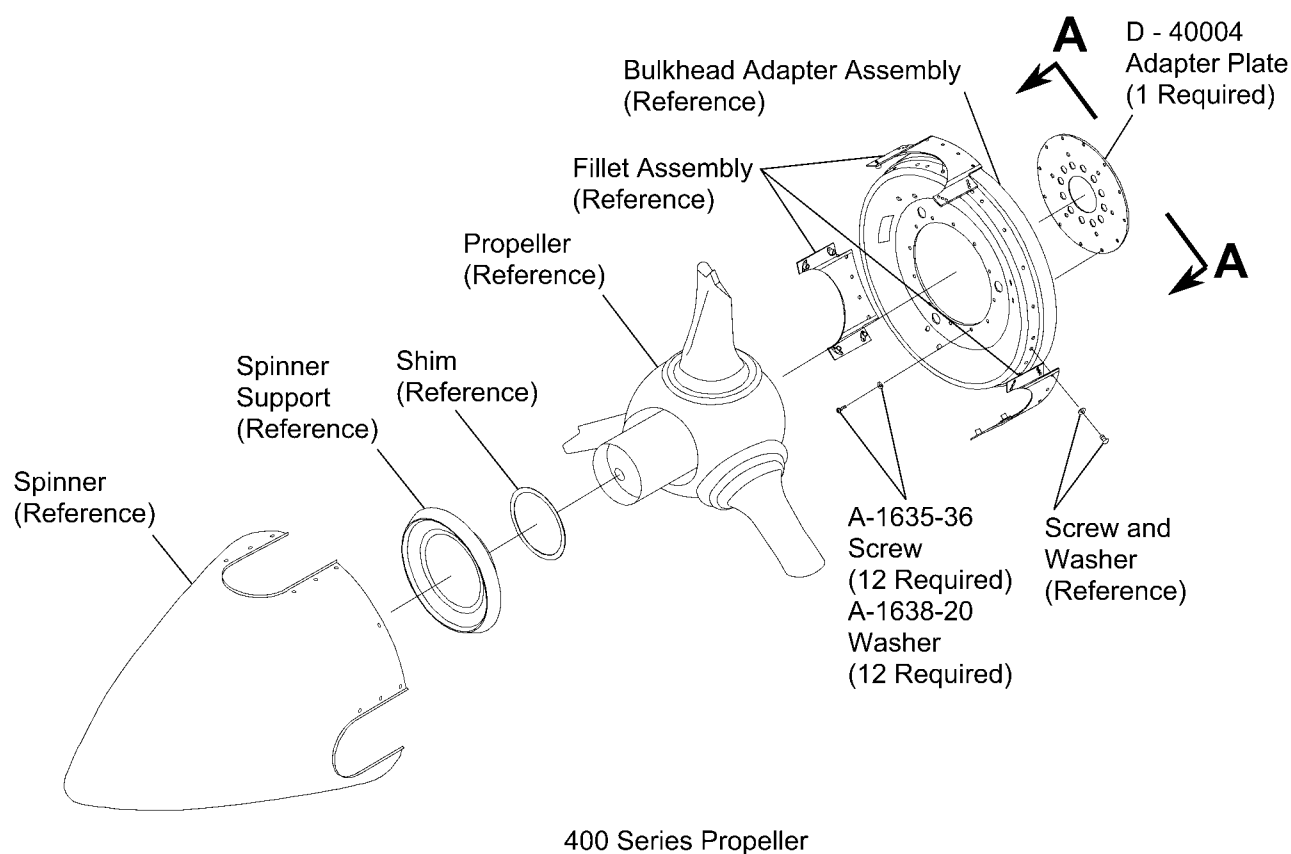

Figure 1. Propeller Adapter Plate Replacement (Sheet 2)



# SERVICE LETTER

**MANDATORY**

**SL2024-2A**

C2848

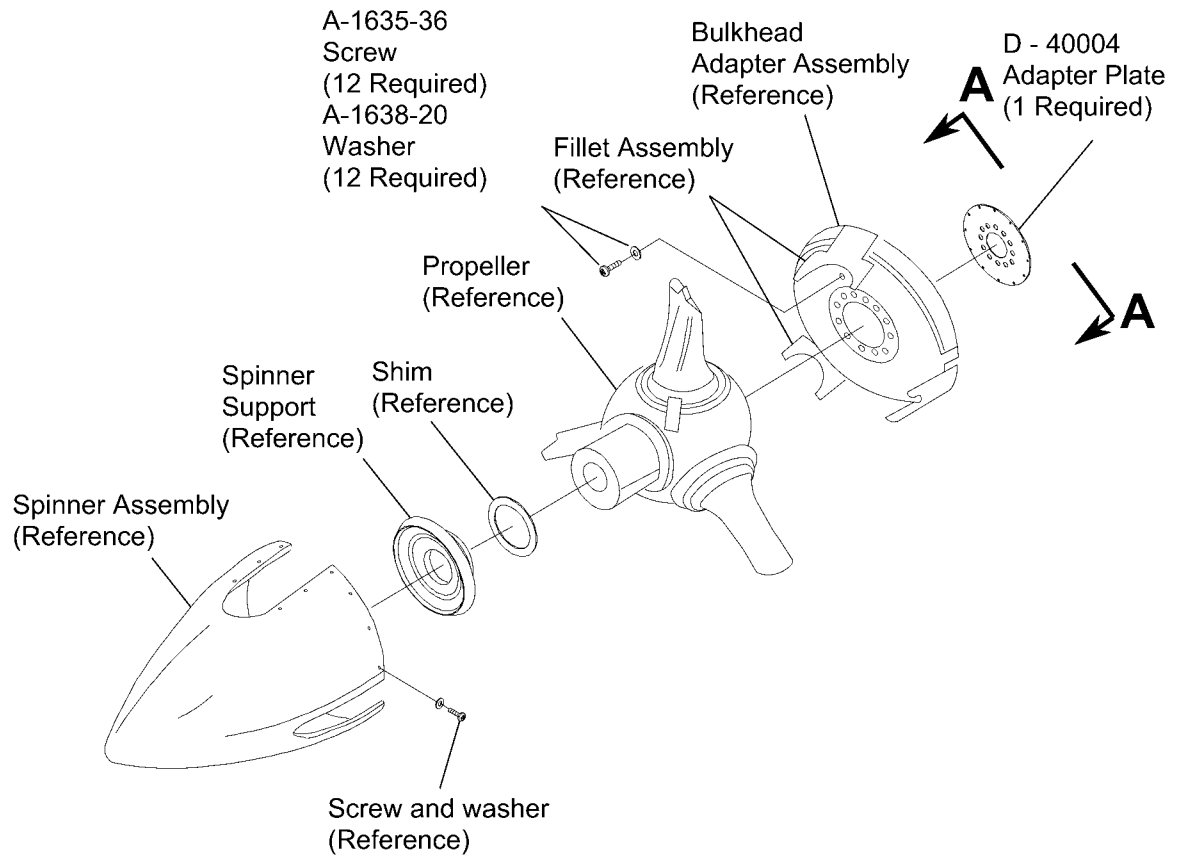

500 Series Propeller

Figure 1. Propeller Adapter Plate Replacement (Sheet 3)

# SERVICE LETTER



**MANDATORY**

**SL2024-2A**

C2849

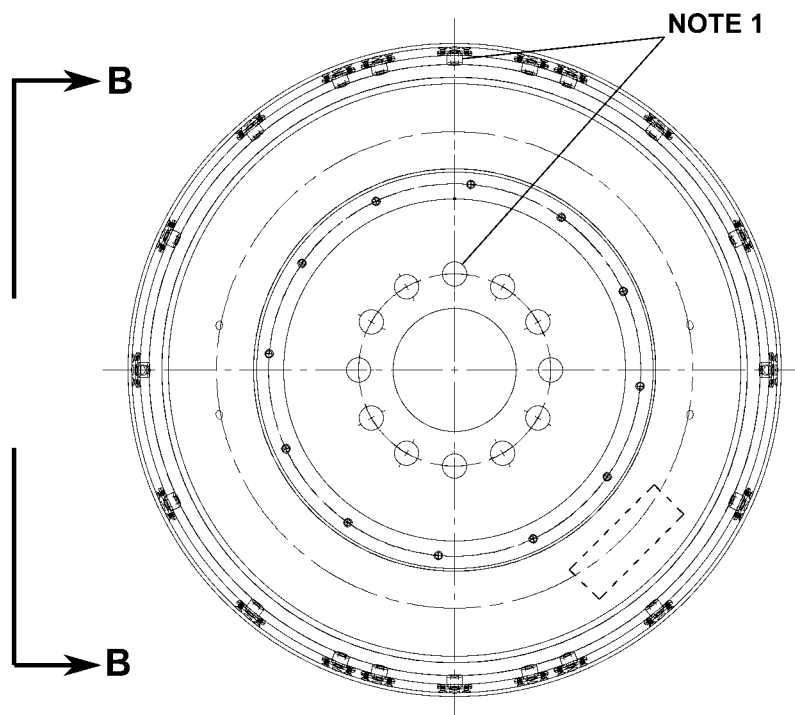

**VIEW A-A**

View Looking Forward At the Spinner Bulkhead

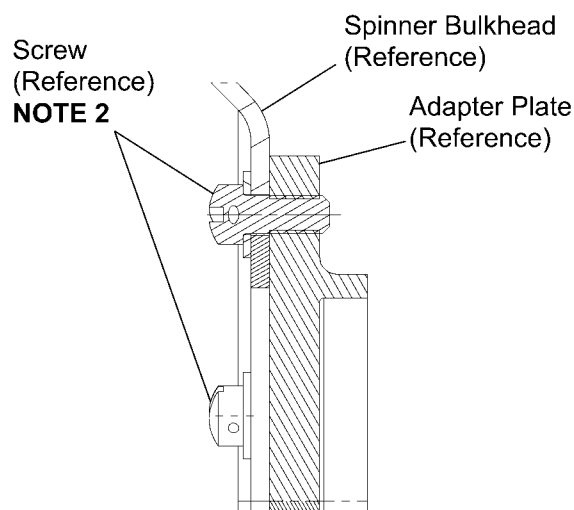

**VIEW B-B**

**NOTE 1:** Align the stud hole with the center nut plate on the spinner bulkhead.

**NOTE 2:** Safety wire the screws in pairs (two) using MS20995C32 Safety Wire.

Figure 1. Propeller Adapter Plate Replacement (Sheet 4)

# SERVICE LETTER



**MANDATORY**

**SL2024-2A**

## MATERIAL INFORMATION

Order the parts below to install this modification.

NEW P/N	QUANTITY	KEY WORD	OLD P/N	INSTRUCTIONS/ DISPOSITION
A-1635-36	12	Screws	A-1635-36	Discard
A-1638-20	12	Washers	A-1638-20	Discard
D-40004	1	Adapter Plate	C-4044	Discard

\* Please contact your Regional Textron Aviation Parts Distribution Customer Support Team for current cost and availability of parts listed in this service document. Phone at 1-800-835-4000 (Domestic) or 1-316-517-5603 (International).

For more information, please visit the TAPD Support & Aftermarket Account Management website at <https://ww2.txtav.com/Parts>.

Based on availability and lead times, parts may require advanced scheduling.

